



Air Conditioning Technical Data

Concealed floor standing unit



EEEN12-204

FXNQ-P

TABLE OF CONTENTS

FXNQ-P

1	Features	2
2	Specifications	3
	Technical Specifications	3
	Electrical Specifications	3
3	Electrical data.....	4
	Electrical Data	4
4	Safety device settings	5
	Safety Device Settings	5
5	Options	6
	Options	6
6	Capacity tables	7
	Cooling Capacity Tables	7
	Heating Capacity Tables	9
7	Dimensional drawings	11
	Dimensional Drawings	11
8	Centre of gravity	13
	Centre of Gravity	13
9	Piping diagrams	14
	Piping Diagrams	14
10	Wiring diagrams	15
	Wiring Diagrams - Single Phase	15
11	Sound data.....	16
	Sound Pressure Spectrum	16

1 Features

- Its low height enables the unit to fit perfectly beneath a window
- Requires very little installation space
- The connecting port faces downward, eliminating the need to attach auxiliary piping
- Allows multi tenant applications (option PCB required)



3 steps



optional



2 Specifications

2-1 Technical Specifications				FXNQ20P	FXNQ25P	FXNQ32P	FXNQ40P	FXNQ50P	FXNQ63P	
Cooling capacity	Nom.	kW		2.2 (1)	2.8 (1)	3.6 (1)	4.5 (1)	5.6 (1)	7.1 (1)	
Heating capacity	Nom.	kW		2.5 (2)	3.2 (2)	4.0 (2)	5.0 (2)	6.3 (2)	8.0 (2)	
Power input - 50Hz	Cooling	Nom.	kW	0.049		0.090		0.110		
	Heating	Nom.	kW	0.049		0.090		0.110		
Casing	Material			Galvanised steel plate						
Dimensions	Unit	Height	mm	610						
		Width	mm	930		1,070		1,350		
		Depth	mm	220						
	Packed unit	Height	mm	665						
		Width	mm	1,128		1,268		1,548		
		Depth	mm	346						
Weight	Unit		kg	19		23		27		
	Packed unit		kg	26		31		36		
Heat exchanger	Rows	Quantity		3						
	Fin pitch		mm	1.5						
	Face area		m ²	0.159		0.200		0.282		
	Stages	Quantity		14						
Fan	Type			Sirocco fan						
	Air flow rate - 50Hz	Cooling	High	m ³ /min	7		8		11	
			Low	m ³ /min	6		8.5		11	
Fan motor	Output	High	W	15		25		35		
	Drive			Direct drive						
Sound pressure level	Cooling	High	dBA	35		38		39		
		Low	dBA	32		33		34		
Refrigerant	Type			R-410A						
	Control			Electronic expansion valve						
Piping connections	Liquid	Type		Flare connection						
		OD	mm	6.35				9.52		
	Gas	Type		Flare connection						
		OD	mm	12.7				15.9		
Heat insulation			Glass Fiber/Urethane Foam							
Temperature control			Microprocessor thermostat for cooling and heating							
Air filter	Type			Resin net						
Safety devices	Item	01		PC board fuse						
		02		Fan motor thermal protection						

2-2 Electrical Specifications				FXNQ20P	FXNQ25P	FXNQ32P	FXNQ40P	FXNQ50P	FXNQ63P
Power supply	Phase			1~					
	Frequency		Hz	50/60					
	Voltage		V	220-240/220					
Current - 50Hz	Minimum circuit amps (MCA)		A	0.3		0.6			
	Maximum fuse amps (MFA)		A	15					
	Full load amps (FLA)	Total	A	0.2		0.5			

Notes

- (1) Cooling: indoor temp. 27°CDB, 19°CWB; outdoor temp. 35°CDB; equivalent piping length: 7.5m (horizontal)
- (2) Heating: indoor temp. 20°CDB; outdoor temp. 7°CDB, 6°CWB; equivalent refrigerant piping: 7.5m (horizontal)
- (3) Capacities are net, including a deduction for cooling (an addition for heating) for indoor fan motor heat.
- (4) Voltage range: units are suitable for use on electrical systems where voltage supplied to unit terminal is not below or above listed range limits.
- (5) Maximum allowable voltage range variation between phases is 2%.
- (6) MCA/MFA: MCA = 1.25 x FLA
- (7) MFA ≤ 4 x FLA
- (8) Next lower standard fuse rating minimum 15A
- (9) Select wire size based on the value of MCA
- (10) Use a circuit breaker instead of a fuse.

3 Electrical data

3 - 1 Electrical Data

3

FXNQ-P

Model	Units			Power supply		IFM		Input (W)	
	Hz	Volts	Voltage range	MCA	MFA	KW	FLA	Cooling	Heating
FXNQ20P	50	220-240	Max. 264 Min. 198	0.3	15	0.015	0.2	49	49
FXNQ25P				0.3	15	0.015	0.2	49	49
FXNQ32P				0.6	15	0.025	0.5	90	90
FXNQ40P				0.6	15	0.025	0.5	90	90
FXNQ50P				0.6	15	0.035	0.5	110	110
FXNQ63P				0.6	15	0.035	0.5	110	110

SYMBOLS

- MCA : Min. Circuit Amps. (A)
- MFA : Max. Fuse Amps. (See note 5)
- kW : Fan Motor Rated Output (kW)
- FLA : Full Load Amps. (A)
- IFM : Indoor Fan Motor

NOTES

1. Voltage range
Units are suitable for use on electrical systems where voltage supplied to unit terminals is not below or above listed range limits.
2. Maximum allowable voltage unbalance between phases is 2%
3. MCA/MFA
MCA + 1.25 X FLA
MFA ≤ 4 X FLA
(next lower standard fuse rating. Min. 15A)
4. Select wire size based on the MCA.
5. Instead of fuse, use Circuit Breaker.

4D034579E

4 Safety device settings

4 - 1 Safety Device Settings

FXNQ-P

Safety devices		20	25	32	40	50	63
FXNQ-P	PC board fuse	250V 10A	250V 10A	250V 10A	250V 10A	250V 10A	250V 10A
	Fan motor thermal protector	°C OFF: 135 ±10 ON: 120 or less	°C OFF: 135 ±10 ON: 120 or less	°C OFF: 135 ±10 ON: 120 or less	°C OFF: 135 ±10 ON: 120 or less	°C OFF: 135 ±10 ON: 120 or less	°C OFF: 135 ±10 ON: 120 or less

3TW32659-2

5 Options

5 - 1 Options

5

FXLQ-P

Item		Type	FXNQ20,25P	FXNQ32,40P	FXNQ50,63P
Remote control	Wired type		BRC1D52 / BRC1E51A*2 BRC1E52A7 *3 / BRC1E52B7 *4		
		Infrared type		BRC4C65	
		HP		BRC4C66	
		CO			
Simplified remote control				BRC2A51	
Remote control for hotel use				BRC3A61	
Adapter for wiring				KRP1B61	
Wiring adapter for electrical appendices (1)				KRP2A51	
Wiring adapter for electrical appendices (2)				KRP4A51	
Remote sensor				KRCS01-1	
Central remote control				DCS302B51	
Electrical box with earth terminal (3 blocks)				KJB311A	
Unified ON/OFF controller				DCS301BA51	
Electrical box with earth terminal (2 blocks)				KJB212A	
Noise filter (for electromagnetic interface use only)				KEK26-1	
Schedule timer				DST301BA51	
External adapter for outdoor unit (installation on indoor unit)				DTA104A61	
Long life replacement filter			KAFJ361K28	KAFJ361K45	KAFJ361K71
Multi tenant *1				EKMTAC	

NOTES

1. This kit contains parts to connect with 10 multi tenant indoor units
2. Included languages are: English, German, French, Dutch, Spanish, Italian, Greek, Portuguese, Russian and Turkish
3. Included languages are: English, German, French, Dutch, Spanish, Italian, Greek, Portuguese, Russian, Turkish and Polish
4. Included languages are: English, German, Albanian, Bulgarian, Croatian, Czech, Hungarian, Romanian, Serbian, Slovak and Slovenian

4TW32299-1C

6 Capacity tables

6 - 1 Cooling Capacity Tables

FXNQ-P		TC: Total capacity;kW - SHC: Sensible capacity;kW															
Unit size	Nominal capacity	Outdoor air temp.	Indoor air temperature														
			14.OWB		16.OWB		18.OWB		19.OWB		20.OWB		22.OWB		24.OWB		
			20.ODB		23.ODB		26.ODB		27.ODB		28.ODB		30.ODB		32.ODB		
		°CDB	TC	SHC	TC	SHC	TC	SHC	TC	SHC	TC	SHC	TC	SHC	TC	SHC	
20	2.2	10.0	1.5	1.3	1.8	1.5	2.1	1.7	2.2	1.7	2.3	1.8	2.6	1.8	2.9	1.8	
		12.0	1.5	1.3	1.8	1.5	2.1	1.7	2.2	1.7	2.3	1.8	2.6	1.8	2.9	1.7	
		14.0	1.5	1.3	1.8	1.5	2.1	1.7	2.2	1.7	2.3	1.8	2.6	1.8	2.8	1.7	
		16.0	1.5	1.3	1.8	1.5	2.1	1.7	2.2	1.7	2.3	1.8	2.6	1.8	2.8	1.7	
		18.0	1.5	1.3	1.8	1.5	2.1	1.7	2.2	1.7	2.3	1.8	2.6	1.8	2.7	1.7	
		20.0	1.5	1.3	1.8	1.5	2.1	1.7	2.2	1.7	2.3	1.8	2.6	1.8	2.7	1.6	
		21.0	1.5	1.3	1.8	1.5	2.1	1.7	2.2	1.7	2.3	1.8	2.6	1.8	2.7	1.6	
		23.0	1.5	1.3	1.8	1.5	2.1	1.7	2.2	1.7	2.3	1.8	2.6	1.8	2.6	1.6	
		25.0	1.5	1.3	1.8	1.5	2.1	1.7	2.2	1.7	2.3	1.8	2.6	1.7	2.6	1.6	
		27.0	1.5	1.3	1.8	1.5	2.1	1.7	2.2	1.7	2.3	1.8	2.5	1.7	2.6	1.6	
		29.0	1.5	1.3	1.8	1.5	2.1	1.7	2.2	1.7	2.3	1.8	2.5	1.7	2.5	1.6	
		31.0	1.5	1.3	1.8	1.5	2.1	1.7	2.2	1.7	2.3	1.8	2.4	1.7	2.5	1.6	
		33.0	1.5	1.3	1.8	1.5	2.1	1.7	2.2	1.7	2.3	1.8	2.4	1.7	2.5	1.6	
		35.0	1.5	1.3	1.8	1.5	2.1	1.7	2.2	1.7	2.3	1.7	2.4	1.6	2.4	1.5	
37.0	1.5	1.3	1.8	1.5	2.1	1.7	2.2	1.7	2.3	1.7	2.3	1.6	2.4	1.6			
39.0	1.5	1.3	1.8	1.5	2.1	1.7	2.2	1.7	2.2	1.7	2.2	1.6	2.3	1.5			
25	2.8	10.0	1.9	1.6	2.3	1.8	2.6	2.0	2.8	2.1	3.0	2.1	3.4	2.1	3.7	2.1	
		12.0	1.9	1.6	2.3	1.8	2.6	2.0	2.8	2.1	3.0	2.1	3.4	2.1	3.6	2.1	
		14.0	1.9	1.6	2.3	1.8	2.6	2.0	2.8	2.1	3.0	2.1	3.4	2.1	3.6	2.1	
		16.0	1.9	1.6	2.3	1.8	2.6	2.0	2.8	2.1	3.0	2.1	3.4	2.1	3.5	2.1	
		18.0	1.9	1.6	2.3	1.8	2.6	2.0	2.8	2.1	3.0	2.1	3.4	2.1	3.5	2.0	
		20.0	1.9	1.6	2.3	1.8	2.6	2.0	2.8	2.1	3.0	2.1	3.4	2.1	3.4	2.0	
		21.0	1.9	1.6	2.3	1.8	2.6	2.0	2.8	2.1	3.0	2.1	3.4	2.1	3.4	2.0	
		23.0	1.9	1.6	2.3	1.8	2.6	2.0	2.8	2.1	3.0	2.1	3.3	2.1	3.4	2.0	
		25.0	1.9	1.6	2.3	1.8	2.6	2.0	2.8	2.1	3.0	2.1	3.3	2.1	3.3	2.0	
		27.0	1.9	1.6	2.3	1.8	2.6	2.0	2.8	2.1	3.0	2.1	3.2	2.1	3.3	1.9	
		29.0	1.9	1.6	2.3	1.8	2.6	2.0	2.8	2.1	3.0	2.1	3.2	2.0	3.2	1.9	
		31.0	1.9	1.6	2.3	1.8	2.6	2.0	2.8	2.1	3.0	2.1	3.1	2.0	3.2	1.9	
		33.0	1.9	1.6	2.3	1.8	2.6	2.0	2.8	2.1	3.0	2.1	3.1	2.0	3.1	1.9	
		35.0	1.9	1.6	2.3	1.8	2.6	2.0	2.8	2.1	3.0	2.1	3.0	2.0	3.1	1.9	
37.0	1.9	1.6	2.3	1.8	2.6	2.0	2.8	2.1	2.9	2.0	3.0	2.0	3.0	1.9			
39.0	1.9	1.6	2.3	1.8	2.6	2.0	2.8	2.1	2.8	2.1	2.9	2.0	3.0	1.9			
32	3.6	10.0	2.4	2.1	2.9	2.2	3.4	2.5	3.6	2.5	3.8	2.6	4.3	2.6	4.7	2.6	
		12.0	2.4	2.1	2.9	2.2	3.4	2.5	3.6	2.5	3.8	2.6	4.3	2.6	4.7	2.6	
		14.0	2.4	2.1	2.9	2.2	3.4	2.5	3.6	2.5	3.8	2.6	4.3	2.6	4.6	2.6	
		16.0	2.4	2.1	2.9	2.2	3.4	2.5	3.6	2.5	3.8	2.6	4.3	2.6	4.6	2.5	
		18.0	2.4	2.1	2.9	2.2	3.4	2.5	3.6	2.5	3.8	2.6	4.3	2.6	4.5	2.5	
		20.0	2.4	2.1	2.9	2.2	3.4	2.5	3.6	2.5	3.8	2.6	4.3	2.6	4.4	2.5	
		21.0	2.4	2.1	2.9	2.2	3.4	2.5	3.6	2.5	3.8	2.6	4.3	2.6	4.4	2.5	
		23.0	2.4	2.1	2.9	2.2	3.4	2.5	3.6	2.5	3.8	2.6	4.2	2.6	4.3	2.4	
		25.0	2.4	2.1	2.9	2.2	3.4	2.5	3.6	2.5	3.8	2.6	4.2	2.6	4.3	2.4	
		27.0	2.4	2.1	2.9	2.2	3.4	2.5	3.6	2.5	3.8	2.6	4.1	2.5	4.2	2.4	
		29.0	2.4	2.1	2.9	2.2	3.4	2.5	3.6	2.5	3.8	2.6	4.1	2.5	4.2	2.4	
		31.0	2.4	2.1	2.9	2.2	3.4	2.5	3.6	2.5	3.8	2.6	4.0	2.5	4.1	2.4	
		33.0	2.4	2.1	2.9	2.2	3.4	2.5	3.6	2.5	3.8	2.6	3.9	2.4	4.0	2.3	
		35.0	2.4	2.1	2.9	2.2	3.4	2.5	3.6	2.5	3.8	2.5	3.9	2.4	4.0	2.3	
37.0	2.4	2.1	2.9	2.2	3.4	2.5	3.6	2.5	3.7	2.5	3.8	2.4	3.9	2.3			
39.0	2.4	2.1	2.9	2.2	3.4	2.5	3.6	2.6	3.7	2.5	3.8	2.4	3.8	2.3			
40	4.5	10.0	3.0	2.5	3.6	2.7	4.2	3.1	4.5	3.1	4.8	3.2	5.4	3.3	5.9	3.3	
		12.0	3.0	2.5	3.6	2.7	4.2	3.1	4.5	3.1	4.8	3.2	5.4	3.3	5.8	3.3	
		14.0	3.0	2.5	3.6	2.7	4.2	3.1	4.5	3.1	4.8	3.2	5.4	3.3	5.8	3.2	
		16.0	3.0	2.5	3.6	2.7	4.2	3.1	4.5	3.1	4.8	3.2	5.4	3.3	5.7	3.2	
		18.0	3.0	2.5	3.6	2.7	4.2	3.1	4.5	3.1	4.8	3.2	5.4	3.3	5.6	3.1	
		20.0	3.0	2.5	3.6	2.7	4.2	3.1	4.5	3.1	4.8	3.2	5.4	3.3	5.5	3.1	
		21.0	3.0	2.5	3.6	2.7	4.2	3.1	4.5	3.1	4.8	3.2	5.4	3.3	5.5	3.1	
		23.0	3.0	2.5	3.6	2.7	4.2	3.1	4.5	3.1	4.8	3.2	5.3	3.2	5.4	3.0	
		25.0	3.0	2.5	3.6	2.7	4.2	3.1	4.5	3.1	4.8	3.2	5.2	3.2	5.3	3.0	
		27.0	3.0	2.5	3.6	2.7	4.2	3.1	4.5	3.1	4.8	3.2	5.2	3.1	5.3	3.0	
		29.0	3.0	2.5	3.6	2.7	4.2	3.1	4.5	3.1	4.8	3.2	5.1	3.1	5.2	3.0	
		31.0	3.0	2.5	3.6	2.7	4.2	3.1	4.5	3.1	4.8	3.2	5.0	3.1	5.1	2.9	
		33.0	3.0	2.5	3.6	2.7	4.2	3.1	4.5	3.1	4.8	3.2	4.9	3.0	5.0	2.9	
		35.0	3.0	2.5	3.6	2.7	4.2	3.1	4.5	3.1	4.7	3.2	4.9	3.1	5.0	2.9	
37.0	3.0	2.5	3.6	2.7	4.2	3.1	4.5	3.1	4.7	3.2	4.8	3.0	4.9	2.8			
39.0	3.0	2.5	3.6	2.7	4.2	3.1	4.5	3.2	4.6	3.1	4.7	3.0	4.8	2.8			

CA03A095

6 Capacity tables

6 - 1 Cooling Capacity Tables

6

FXNQ-P

TC: Total capacity;KW - SHC: Sensible capacity;KW

Unit size	Nominal capacity	Outdoor air temp. °CDB	Indoor air temperature													
			14.OWB		16.OWB		18.OWB		19.OWB		20.OWB		22.OWB		24.OWB	
			20.ODB		23.ODB		26.ODB		27.ODB		28.ODB		30.ODB		32.ODB	
			TC	SHC	TC	SHC	TC	SHC	TC	SHC	TC	SHC	TC	SHC	TC	SHC
50	5.6	10.0	3.8	3.0	4.5	3.4	5.2	3.8	5.6	3.9	6.0	4.0	6.7	4.1	7.4	4.1
		12.0	3.8	3.0	4.5	3.4	5.2	3.8	5.6	3.9	6.0	4.0	6.7	4.1	7.3	4.1
		14.0	3.8	3.0	4.5	3.4	5.2	3.8	5.6	3.9	6.0	4.0	6.7	4.1	7.2	4.0
		16.0	3.8	3.0	4.5	3.4	5.2	3.8	5.6	3.9	6.0	4.0	6.7	4.1	7.1	4.0
		18.0	3.8	3.0	4.5	3.4	5.2	3.8	5.6	3.9	6.0	4.0	6.7	4.1	7.0	3.9
		20.0	3.8	3.0	4.5	3.4	5.2	3.8	5.6	3.9	6.0	4.0	6.7	4.1	6.9	3.9
		21.0	3.8	3.0	4.5	3.4	5.2	3.8	5.6	3.9	6.0	4.0	6.7	4.1	6.8	3.8
		23.0	3.8	3.0	4.5	3.4	5.2	3.8	5.6	3.9	6.0	4.0	6.6	4.0	6.7	3.8
		25.0	3.8	3.0	4.5	3.4	5.2	3.8	5.6	3.9	6.0	4.0	6.5	4.0	6.6	3.7
		27.0	3.8	3.0	4.5	3.4	5.2	3.8	5.6	3.9	6.0	4.0	6.4	3.9	6.6	3.7
		29.0	3.8	3.0	4.5	3.4	5.2	3.8	5.6	3.9	6.0	4.0	6.3	3.9	6.5	3.7
		31.0	3.8	3.0	4.5	3.4	5.2	3.8	5.6	3.9	6.0	4.0	6.2	3.8	6.4	3.7
		33.0	3.8	3.0	4.5	3.4	5.2	3.8	5.6	3.9	6.0	4.0	6.1	3.8	6.3	3.6
		35.0	3.8	3.0	4.5	3.4	5.2	3.8	5.6	3.9	5.9	4.0	6.0	3.8	6.2	3.6
37.0	3.8	3.0	4.5	3.4	5.2	3.8	5.6	3.9	5.8	3.9	5.9	3.7	6.1	3.6		
39.0	3.8	3.0	4.5	3.4	5.2	3.8	5.6	3.9	5.7	3.9	5.8	3.7	6.0	3.5		
63	7.1	10.0	4.8	3.7	5.7	4.2	6.6	4.8	7.1	4.9	7.6	5.0	8.5	5.1	9.3	5.0
		12.0	4.8	3.7	5.7	4.2	6.6	4.8	7.1	4.9	7.6	5.0	8.5	5.1	9.2	5.0
		14.0	4.8	3.7	5.7	4.2	6.6	4.8	7.1	4.9	7.6	5.0	8.5	5.1	9.1	4.9
		16.0	4.8	3.7	5.7	4.2	6.6	4.8	7.1	4.9	7.6	5.0	8.5	5.1	9.0	4.8
		18.0	4.8	3.7	5.7	4.2	6.6	4.8	7.1	4.9	7.6	5.0	8.5	5.1	8.8	4.8
		20.0	4.8	3.7	5.7	4.2	6.6	4.8	7.1	4.9	7.6	5.0	8.5	5.1	8.7	4.7
		21.0	4.8	3.7	5.7	4.2	6.6	4.8	7.1	4.9	7.6	5.0	8.5	5.1	8.7	4.7
		23.0	4.8	3.7	5.7	4.2	6.6	4.8	7.1	4.9	7.6	5.0	8.4	5.0	8.5	4.6
		25.0	4.8	3.7	5.7	4.2	6.6	4.8	7.1	4.9	7.6	5.0	8.3	5.0	8.4	4.5
		27.0	4.8	3.7	5.7	4.2	6.6	4.8	7.1	4.9	7.6	5.0	8.1	4.9	8.3	4.5
		29.0	4.8	3.7	5.7	4.2	6.6	4.8	7.1	4.9	7.6	5.0	8.0	4.8	8.2	4.5
		31.0	4.8	3.7	5.7	4.2	6.6	4.8	7.1	4.9	7.6	5.0	7.9	4.7	8.1	4.4
		33.0	4.8	3.7	5.7	4.2	6.6	4.8	7.1	4.9	7.6	5.0	7.8	4.7	7.9	4.4
		35.0	4.8	3.7	5.7	4.2	6.6	4.8	7.1	4.9	7.5	4.9	7.7	4.7	7.8	4.3
37.0	4.8	3.7	5.7	4.2	6.6	4.8	7.1	4.9	7.4	4.9	7.5	4.6	7.7	4.2		
39.0	4.8	3.7	5.7	4.2	6.6	4.8	7.1	4.9	7.2	4.8	7.4	4.6	7.6	4.2		

CA03A095

6 Capacity tables

6 - 2 Heating Capacity Tables

FXNQ-P									
Unit Size	Nominal capacity	Outdoor air temperature		Indoor air temperature °CDB					
				16.0	18.0	20.0		21.0	22.0
		°CDB	°CWB	kW	kW	kW	kW	kW	kW
20	2.5	-19.8	-20.0	1.5	1.5	1.5	1.5	1.5	1.5
		-18.8	-19.0	1.5	1.5	1.5	1.5	1.5	1.5
		-16.7	-17.0	1.6	1.6	1.6	1.6	1.6	1.6
		-14.7	-15.0	1.7	1.7	1.7	1.7	1.7	1.7
		-12.6	-13.0	1.8	1.8	1.8	1.8	1.8	1.8
		-10.5	-11.0	1.9	1.9	1.9	1.9	1.9	1.9
		-9.5	-10.0	1.9	1.9	1.9	1.9	1.9	1.9
		-8.5	-9.1	2.0	2.0	1.9	1.9	1.9	1.9
		-7.0	-7.6	2.0	2.0	2.0	2.0	2.0	2.0
		-5.0	-5.6	2.1	2.1	2.1	2.1	2.1	2.1
		-3.0	-3.7	2.2	2.2	2.2	2.2	2.2	2.2
		0.0	-0.7	2.3	2.3	2.3	2.3	2.3	2.2
		3.0	2.2	2.5	2.5	2.4	2.4	2.3	2.2
		5.0	4.1	2.5	2.5	2.5	2.4	2.3	2.2
		7.0	6.0	2.6	2.6	2.5	2.4	2.3	2.2
		9.0	7.9	2.7	2.7	2.5	2.4	2.3	2.2
		11.0	9.8	2.8	2.7	2.5	2.4	2.3	2.2
13.0	11.8	2.8	2.7	2.5	2.4	2.3	2.2		
15.0	13.7	2.8	2.7	2.5	2.4	2.3	2.2		
25	3.2	-19.8	-20.0	1.9	1.9	1.9	1.9	1.9	1.9
		-18.8	-19.0	1.9	1.9	1.9	1.9	1.9	1.9
		-16.7	-17.0	2.1	2.1	2.0	2.0	2.0	2.0
		-14.7	-15.0	2.2	2.2	2.2	2.2	2.2	2.1
		-12.6	-13.0	2.3	2.3	2.3	2.3	2.3	2.3
		-10.5	-11.0	2.4	2.4	2.4	2.4	2.4	2.4
		-9.5	-10.0	2.5	2.4	2.4	2.4	2.4	2.4
		-8.5	-9.1	2.5	2.5	2.5	2.5	2.5	2.5
		-7.0	-7.6	2.6	2.6	2.6	2.6	2.6	2.6
		-5.0	-5.6	2.7	2.7	2.7	2.7	2.7	2.7
		-3.0	-3.7	2.8	2.8	2.8	2.8	2.8	2.8
		0.0	-0.7	3.0	3.0	3.0	3.0	3.0	2.8
		3.0	2.2	3.1	3.1	3.1	3.1	3.0	2.8
		5.0	4.1	3.3	3.2	3.2	3.1	3.0	2.8
		7.0	6.0	3.4	3.4	3.2	3.1	3.0	2.8
		9.0	7.9	3.5	3.4	3.2	3.1	3.0	2.8
		11.0	9.8	3.6	3.4	3.2	3.1	3.0	2.8
13.0	11.8	3.6	3.4	3.2	3.1	3.0	2.8		
15.0	13.7	3.6	3.4	3.2	3.1	3.0	2.8		
32	4.0	-19.8	-20.0	2.4	2.4	2.3	2.3	2.3	2.3
		-18.8	-19.0	2.4	2.4	2.4	2.4	2.4	2.4
		-16.7	-17.0	2.6	2.6	2.6	2.6	2.6	2.5
		-14.7	-15.0	2.7	2.7	2.7	2.7	2.7	2.7
		-12.6	-13.0	2.9	2.8	2.8	2.8	2.8	2.8
		-10.5	-11.0	3.0	3.0	3.0	3.0	3.0	3.0
		-9.5	-10.0	3.1	3.1	3.1	3.1	3.0	3.0
		-8.5	-9.1	3.1	3.1	3.1	3.1	3.1	3.1
		-7.0	-7.6	3.2	3.2	3.2	3.2	3.2	3.2
		-5.0	-5.6	3.4	3.4	3.4	3.4	3.4	3.4
		-3.0	-3.7	3.5	3.5	3.5	3.5	3.5	3.5
		0.0	-0.7	3.7	3.7	3.7	3.7	3.7	3.5
		3.0	2.2	3.9	3.9	3.9	3.9	3.7	3.5
		5.0	4.1	4.1	4.1	4.0	3.9	3.7	3.5
		7.0	6.0	4.2	4.2	4.0	3.9	3.7	3.5
		9.0	7.9	4.3	4.3	4.0	3.9	3.7	3.5
		11.0	9.8	4.5	4.3	4.0	3.9	3.7	3.5
13.0	11.8	4.5	4.3	4.0	3.9	3.7	3.5		
15.0	13.7	4.5	4.3	4.0	3.9	3.7	3.5		
40	5.0	-19.8	-20.0	3.0	2.9	2.9	2.9	2.9	2.9
		-18.8	-19.0	3.0	3.0	3.0	3.0	3.0	3.0
		-16.7	-17.0	3.2	3.2	3.2	3.2	3.2	3.2
		-14.7	-15.0	3.4	3.4	3.4	3.4	3.4	3.4
		-12.6	-13.0	3.6	3.6	3.6	3.5	3.5	3.5
		-10.5	-11.0	3.7	3.7	3.7	3.7	3.7	3.7
		-9.5	-10.0	3.8	3.8	3.8	3.8	3.8	3.8
		-8.5	-9.1	3.9	3.9	3.9	3.9	3.9	3.9
		-7.0	-7.6	4.0	4.0	4.0	4.0	4.0	4.0
		-5.0	-5.6	4.2	4.2	4.2	4.2	4.2	4.2
		-3.0	-3.7	4.4	4.4	4.4	4.4	4.4	4.4
		0.0	-0.7	4.7	4.6	4.6	4.6	4.6	4.4
		3.0	2.2	4.9	4.9	4.9	4.8	4.7	4.4
		5.0	4.1	5.1	5.1	5.0	4.8	4.7	4.4
		7.0	6.0	5.2	5.2	5.0	4.8	4.7	4.4
		9.0	7.9	5.4	5.3	5.0	4.8	4.7	4.4
		11.0	9.8	5.6	5.3	5.0	4.8	4.7	4.4
13.0	11.8	5.6	5.3	5.0	4.8	4.7	4.4		
15.0	13.7	5.6	5.3	5.0	4.8	4.7	4.4		

CA03A095

6 Capacity tables

6 - 2 Heating Capacity Tables

6

FXNQ-P

Unit Size	Nominal capacity	Outdoor air temperature		Indoor air temperature °CDB					
				16.0	18.0	20.0	21.0	22.0	24.0
		°CDB	°CWB	kW	kW	kW	kW	kW	kW
50	6.3	-19.8	-20.0	3.7	3.7	3.7	3.7	3.7	3.7
		-18.8	-19.0	3.8	3.8	3.8	3.8	3.8	3.8
		-16.7	-17.0	4.1	4.0	4.0	4.0	4.0	4.0
		-14.7	-15.0	4.3	4.3	4.3	4.2	4.2	4.2
		-12.6	-13.0	4.5	4.5	4.5	4.5	4.5	4.5
		-10.5	-11.0	4.7	4.7	4.7	4.7	4.7	4.7
		-9.5	-10.0	4.8	4.8	4.8	4.8	4.8	4.8
		-8.5	-9.1	4.9	4.9	4.9	4.9	4.9	4.9
		-7.0	-7.6	5.1	5.1	5.1	5.1	5.1	5.1
		-5.0	-5.6	5.3	5.3	5.3	5.3	5.3	5.3
		-3.0	-3.7	5.5	5.5	5.5	5.5	5.5	5.5
		0.0	-0.7	5.9	5.9	5.8	5.8	5.8	5.5
		3.0	2.2	6.2	6.2	6.2	6.1	5.9	5.5
		5.0	4.1	6.4	6.4	6.3	6.1	5.9	5.5
		7.0	6.0	6.6	6.6	6.3	6.1	5.9	5.5
		9.0	7.9	6.8	6.7	6.3	6.1	5.9	5.5
		11.0	9.8	7.0	6.7	6.3	6.1	5.9	5.5
13.0	11.8	7.1	6.7	6.3	6.1	5.9	5.5		
15.0	13.7	7.1	6.7	6.3	6.1	5.9	5.5		
63	8.0	-19.8	-20.0	4.7	4.7	4.7	4.7	4.7	4.7
		-18.8	-19.0	4.9	4.9	4.8	4.8	4.8	4.8
		-16.7	-17.0	5.1	5.1	5.1	5.1	5.1	5.1
		-14.7	-15.0	5.4	5.4	5.4	5.4	5.4	5.4
		-12.6	-13.0	5.7	5.7	5.7	5.7	5.7	5.7
		-10.5	-11.0	6.0	6.0	6.0	6.0	6.0	5.9
		-9.5	-10.0	6.1	6.1	6.1	6.1	6.1	6.1
		-8.5	-9.1	6.3	6.3	6.2	6.2	6.2	6.2
		-7.0	-7.6	6.5	6.5	6.4	6.4	6.4	6.4
		-5.0	-5.6	6.8	6.7	6.7	6.7	6.7	6.7
		-3.0	-3.7	7.0	7.0	7.0	7.0	7.0	7.0
		0.0	-0.7	7.5	7.4	7.4	7.4	7.4	7.0
		3.0	2.2	7.9	7.8	7.8	7.7	7.5	7.0
		5.0	4.1	8.1	8.1	8.0	7.7	7.5	7.0
		7.0	6.0	8.4	8.4	8.0	7.7	7.5	7.0
		9.0	7.9	8.7	8.5	8.0	7.7	7.5	7.0
		11.0	9.8	8.9	8.5	8.0	7.7	7.5	7.0
13.0	11.8	9.0	8.5	8.0	7.7	7.5	7.0		
15.0	13.7	9.0	8.5	8.0	7.7	7.5	7.0		

CA03A095

7 Dimensional drawings

7 - 1 Dimensional Drawings

FXNQ20-25P

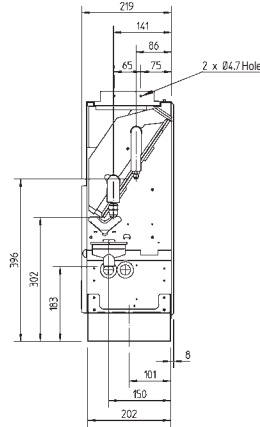
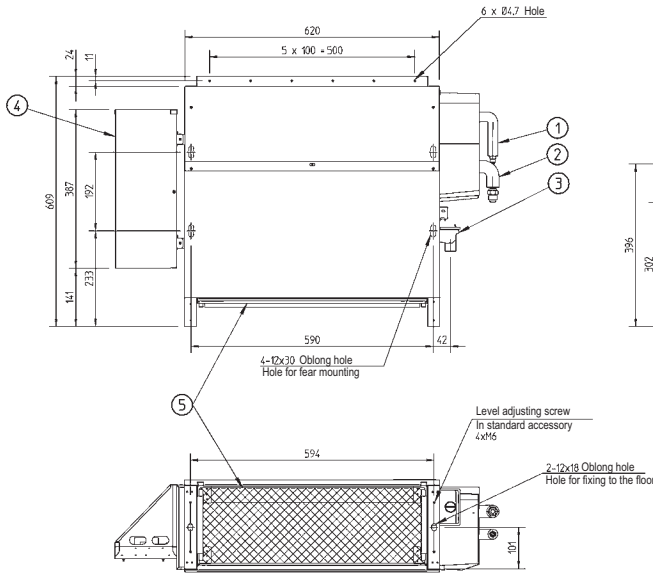
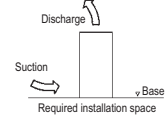
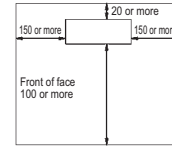
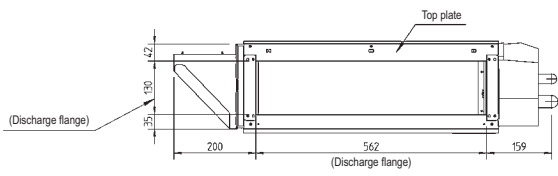

Nr	Name	Description
1	Liquid pipe connection	Ø6.4 Flare connection
2	Gas pipe connection	Ø12.7 Flare connection
3	Drain pipe connection	O.D. Ø21
4	Switch box	
5	Air filter	

3TW32834-1

FXNQ32-40P

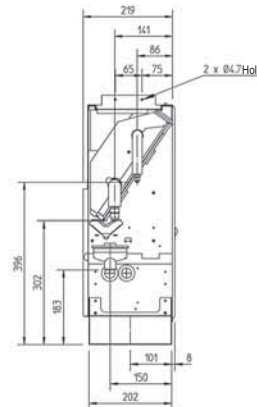
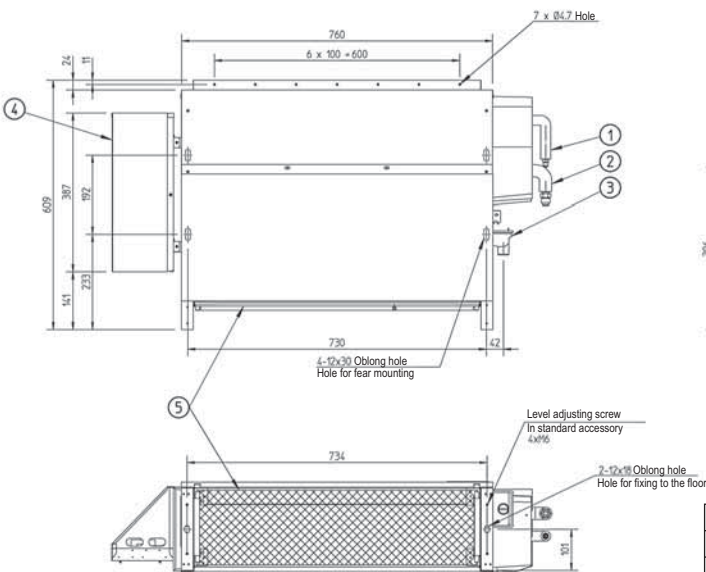
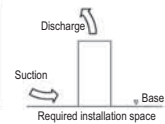
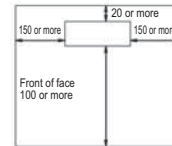
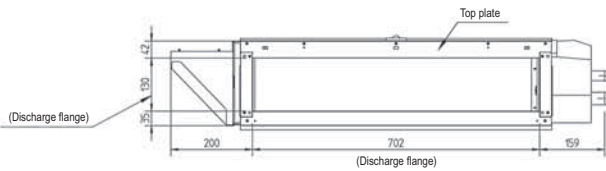

Nr	Name	Description
1	Liquid pipe connection	Ø6.4 Flare connection
2	Gas pipe connection	Ø12.7 Flare connection
3	Drain pipe connection	O.D. Ø21
4	Switch box	
5	Air filter	

3TW32854-1

7 Dimensional drawings

7 - 1 Dimensional Drawings

FXNQ50-63P

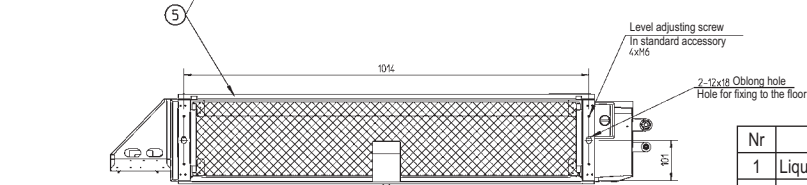
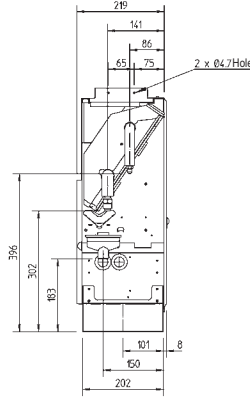
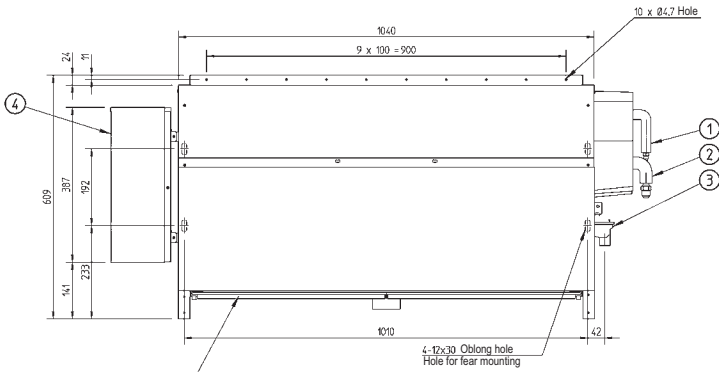
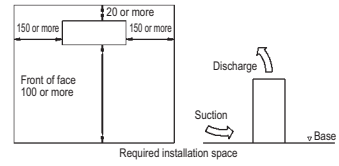
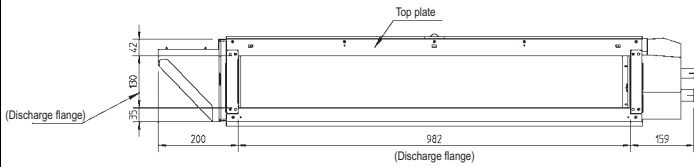

Model	A	B
FXNQ50	Ø6.4	Ø12.7
FXNQ63	Ø9.5	Ø15.9

Nr	Name	Description
1	Liquid pipe connection	Ø A Flare connection
2	Gas pipe connection	Ø B Flare connection
3	Drain pipe connection	O.D. Ø21
4	Switch box	
5	Air filter	

3TW32874-1

8 Centre of gravity

8 - 1 Centre of Gravity

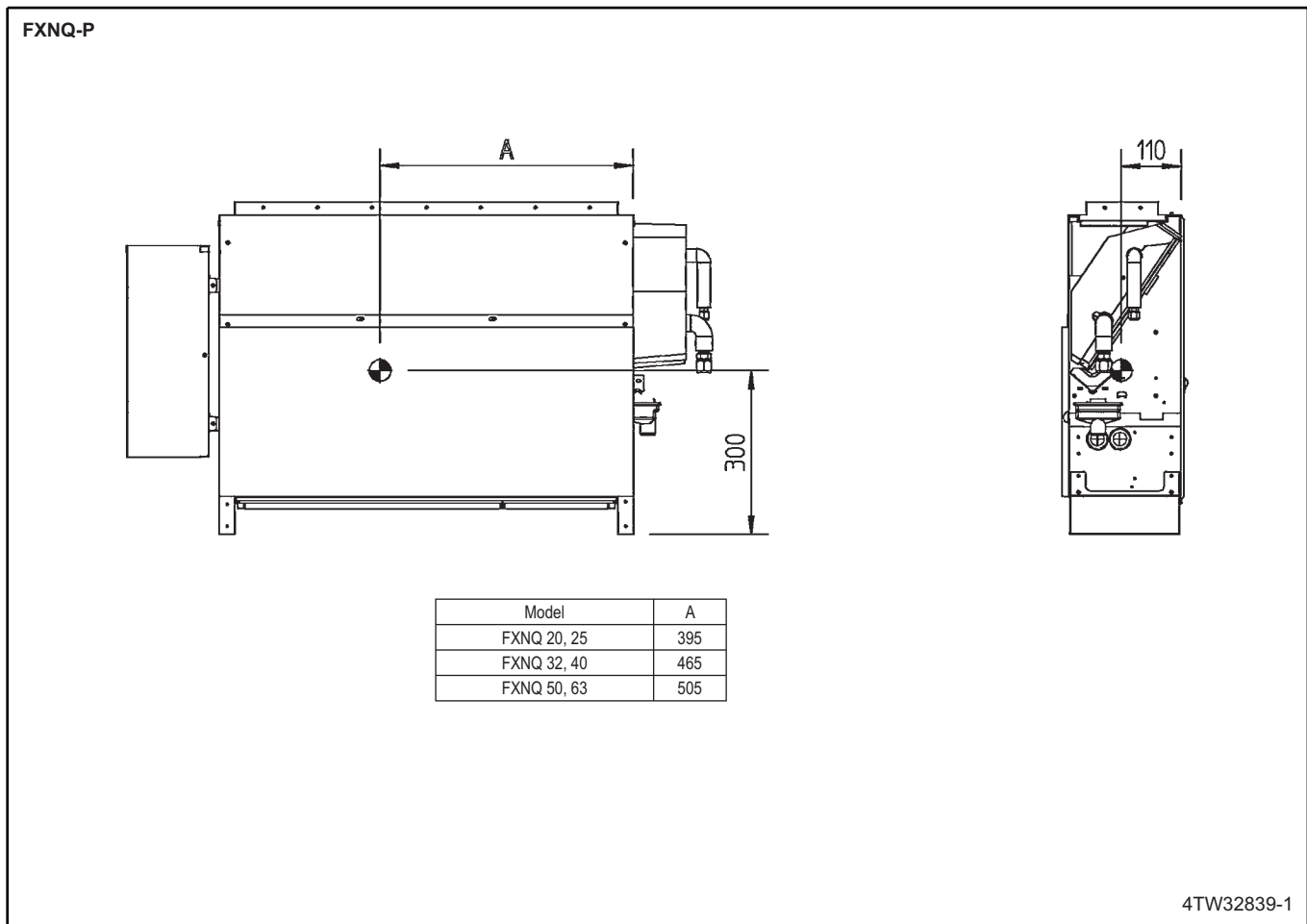

9 Piping diagrams

9 - 1 Piping Diagrams

9

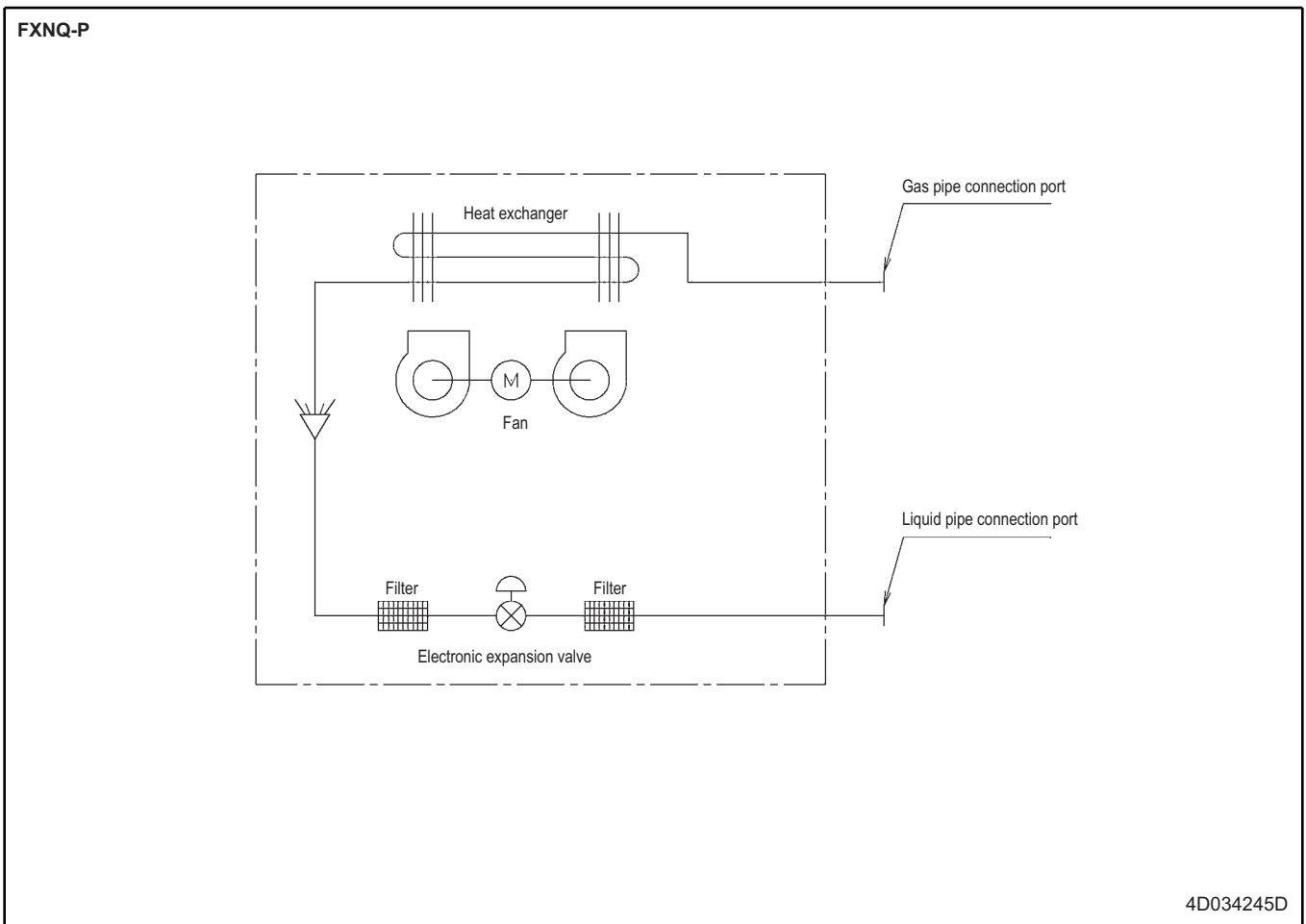

10 Wiring diagrams

10 - 1 Wiring Diagrams - Single Phase

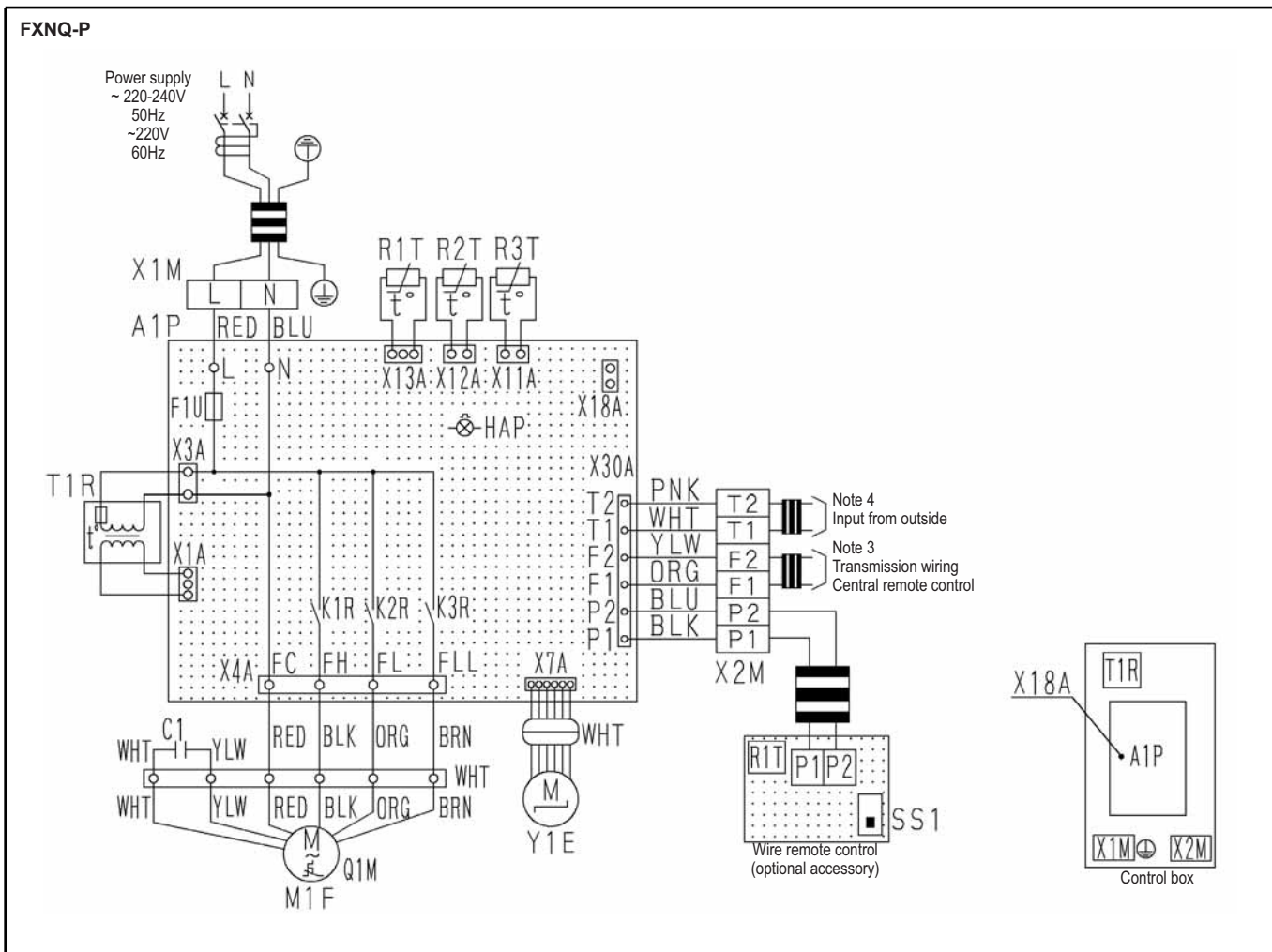

Indoor unit		Y1E	Electronic expansion valve
A1P	Printed circuit board		
C1	Capacitor (M1F)	Wired remote control	
F1U	Fuse (⊙, 5A, 250V)	R1T	Thermistor (air)
HAP	Light emitting diode (service monitor green)	SS1	Select switch (main/sub)
K1R-K3R	Magnetic relay (M1F)		
M1F	Motor (indoor fan)	Connector for optional parts	
Q1M	Thermo switch (M1F embedded)		
R1T	Thermistor (air)	X18A	Connector (wiring adapter for electrical appendices)
R2T-R3T	Thermistor (coil)		
T1R	Transformer (220-240V/22V)		
X1M	Terminal block (power)		
X2M	Terminal block (control)		

PNK: pink	WHT: white
YLV: yellow	ORG: orange
BLU: blue	BLK: black
RED: red	BRN: brown

3D039826G

NOTES

- : terminal block, □○□, D— : connector, -○- : terminal
- ⚡ : field wiring
- In case using central remote control, connect it to the unit in accordance with the attached instruction manual.
- When connecting the input wires from outside, forced OFF or ON/OFF refer to the installation manual attached to the unit.
- Use copper conductors only.

11 Sound data

11 - 1 Sound Pressure Spectrum

FXNQ20-25P

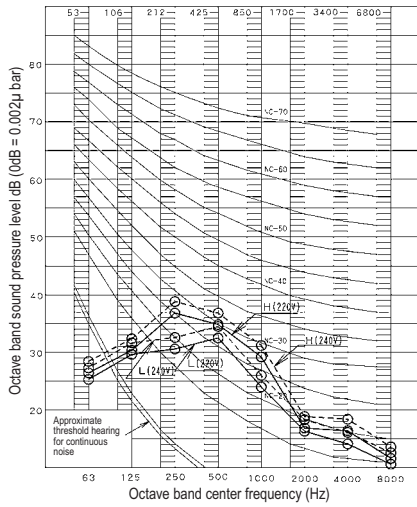

4D034534B

NOTES

- Over All (dB): (B,G,N is already rectified)
- Operating conditions:
Power source: 220 - 240V/22V 50/60Hz
JIS standard
- — ○ 220V ○ - - - - ○ 240V
- Measuring place: Anechoic chamber
- Operation noise differs with operation and ambient conditions
- Location of microphone.

Scale	220V		240V	
	H	L	H	L
A	35	32	37	34
C	40	36.5	42	38.5

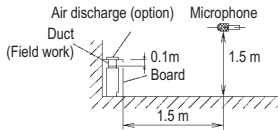

FXNQ32P

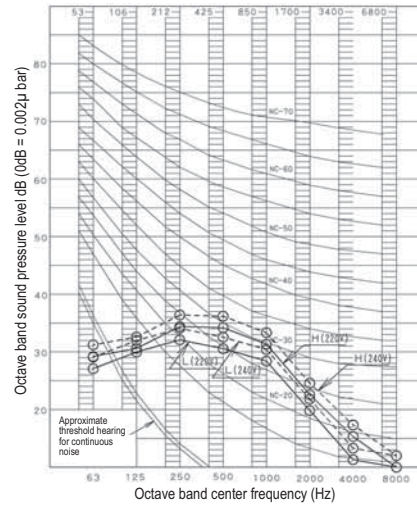

4D034535A

NOTES

- Over All (dB): (B,G,N is already rectified)
- Operating conditions:
Power source: 220 - 240V/22V 50/60Hz
JIS standard
- — ○ 220V ○ - - - - ○ 240V
- Measuring place: Anechoic chamber
- Operation noise differs with operation and ambient conditions
- Location of microphone.

Scale	220V		240V	
	H	L	H	L
A	35	32	37	34
C	39	37	41	39

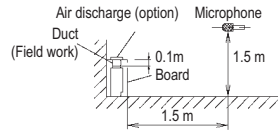

FXNQ40P

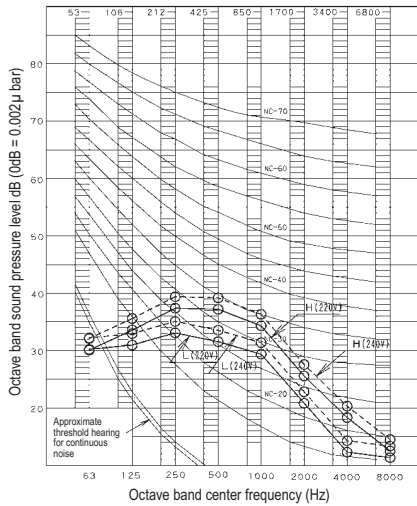

4D034536B

NOTES

- Over All (dB): (B,G,N is already rectified)
- Operating conditions:
Power source: 220 - 240V/22V 50/60Hz
JIS standard
- — ○ 220V ○ - - - - ○ 240V
- Measuring place: Anechoic chamber
- Operation noise differs with operation and ambient conditions
- Location of microphone.

Scale	220V		240V	
	H	L	H	L
A	38	33	40	35
C	42	38	44	40

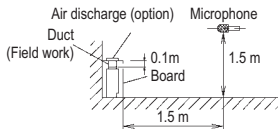

FXNQ50P

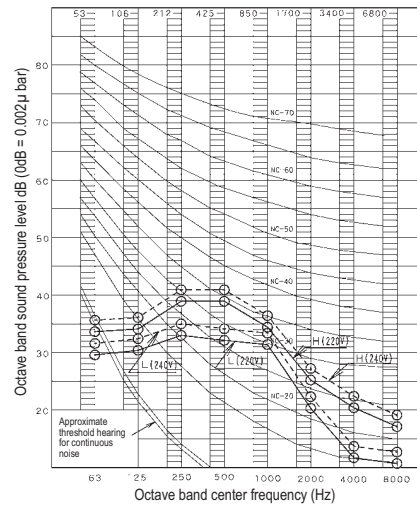

4D034537B

NOTES

- Over All (dB): (B,G,N is already rectified)
- Operating conditions:
Power source: 220 - 240V/22V 50/60Hz
JIS standard
- — ○ 220V ○ - - - - ○ 240V
- Measuring place: Anechoic chamber
- Operation noise differs with operation and ambient conditions
- Location of microphone.

Scale	220V		240V	
	H	L	H	L
A	39	34	41	36
C	44	38.5	46	40.5

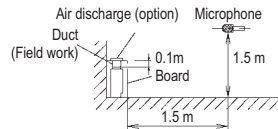

11 Sound data

11 - 1 Sound Pressure Spectrum

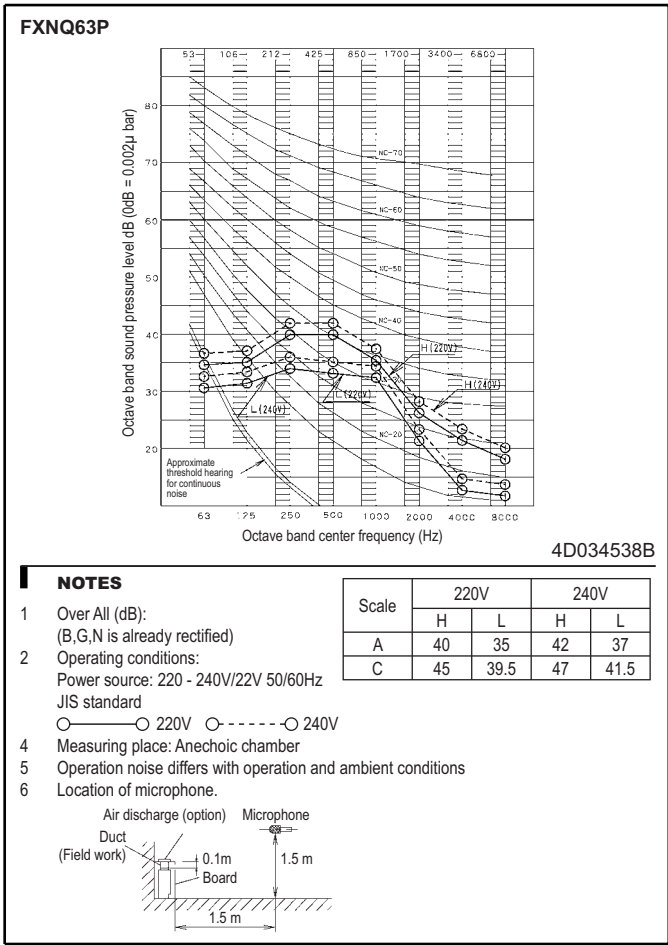



Daikin's unique position as a manufacturer of air conditioning equipment, compressors and refrigerants has led to its close involvement in environmental issues. For several years Daikin has had the intention to become a leader in the provision of products that have limited impact on the environment. This challenge demands the eco design and development of a wider range of products and an energy management system, resulting in energy conservation and a reduction of waste.



The present leaflet is drawn up by way of information only and does not constitute an offer binding upon Daikin Europe N.V.. Daikin Europe N.V. has compiled the content of this leaflet to the best of its knowledge. No express or implied warranty is given for the completeness, accuracy, reliability or fitness for particular purpose of its content and the products and services presented therein. Specifications are subject to change without prior notice. Daikin Europe N.V. explicitly rejects any liability for any direct or indirect damage, in the broadest sense, arising from or related to the use and/or interpretation of this leaflet. All content is copyrighted by Daikin Europe N.V.

BARCODE

Daikin products are distributed by:

